

CAST REQUIRED:

Hot Shoe
Attachment

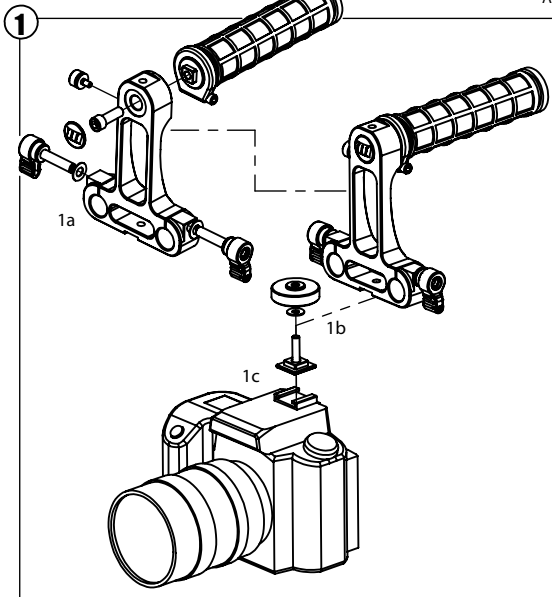

(1a) Assemble microHandle Plus:
 Attach Grip to Handle using Screw.
 Once assembled, attach Redrock
 micro Logo Sticker. Add 2 blue
 knobs to side of Handle

(1b) Attach microshoe attach-
 ment to microHandle by threading
 the shoe part through the bottom
 of the handle. Once shoe is in
 place, attach washer and screw to
 complete assembly

(1c) Attach microShoe / micro-
 Handle assembly to camera

NOTE: The microHandle Plus is
 only recommended for unibody
 DSLR Cameras

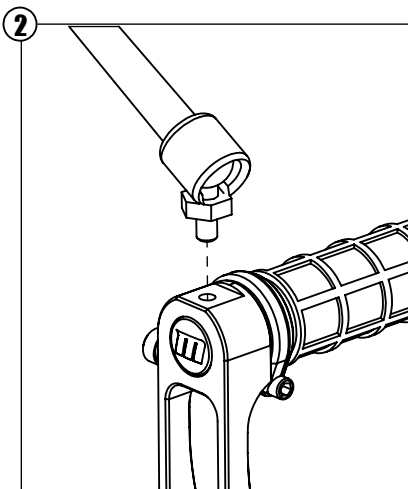

OPTIONAL microArm Attachment

microArm can be threaded to
 microHandle to allow attachment
 of additional accessories.

