

CAST REQUIRED:

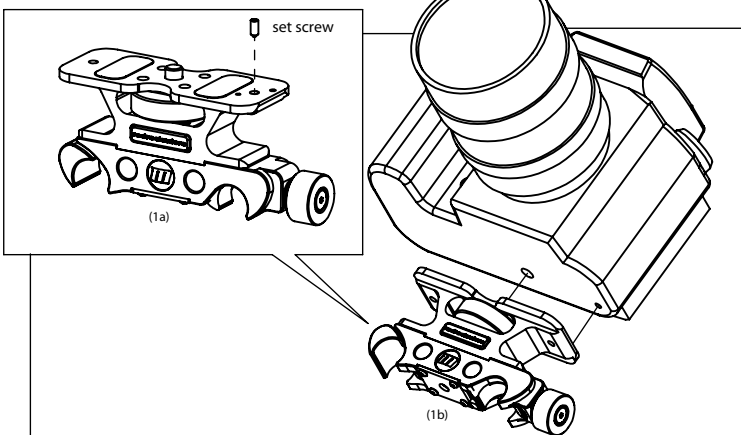

① Steps needed for the Camera / DSLR Baseplate Assembly

1a: Attach appropriate set screw for camera to baseplate.  
1b: Attach Camera to DSLR Baseplate

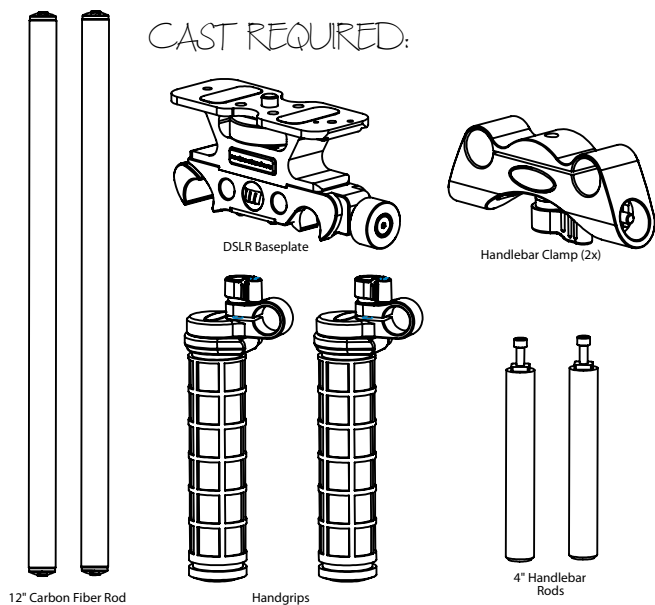
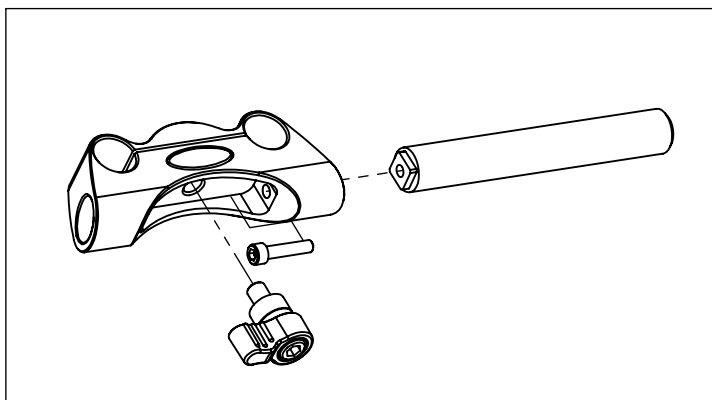

② Steps needed to assemble the Handlebar CLamp:

2a: Attach 4" Handlebar Rod to Handlebar Clamp.  
2b: Thread Handlebar Clamp Tightening Screw  
2c: Repeat this step for the 2nd handlebar clamp and rod

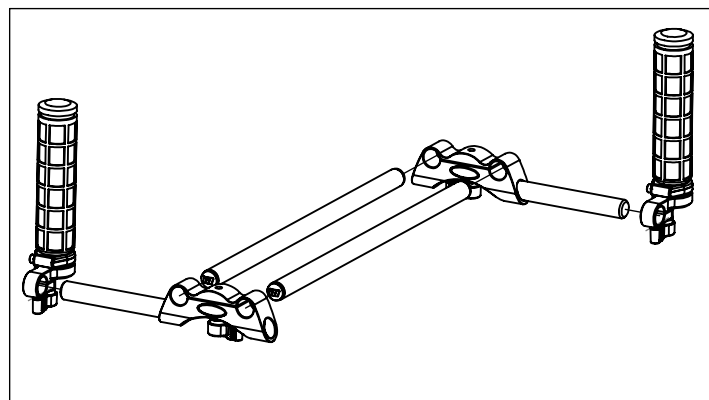

③ Steps needed for CF Rods / Grip Rods / Hand Grip Assembly:

3a: Insert Carbon Fiber Rods into Handlebar Clamp  
3b: Add Handgrips to Carbon Fiber Rods

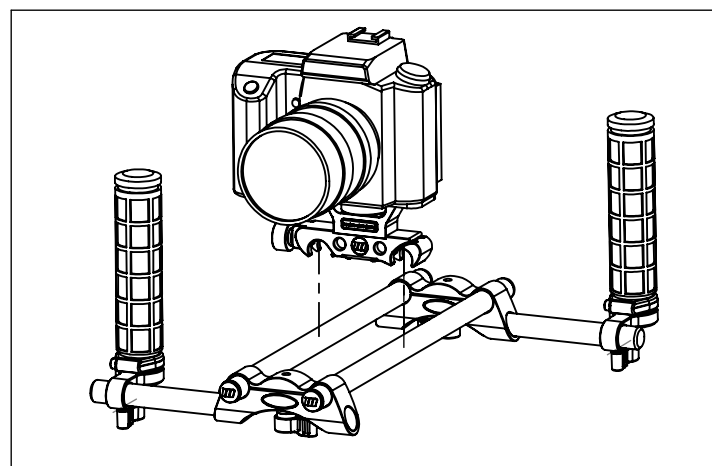

④ Attach Camera / DSLR Baseplate Assembly to CF Support Rods

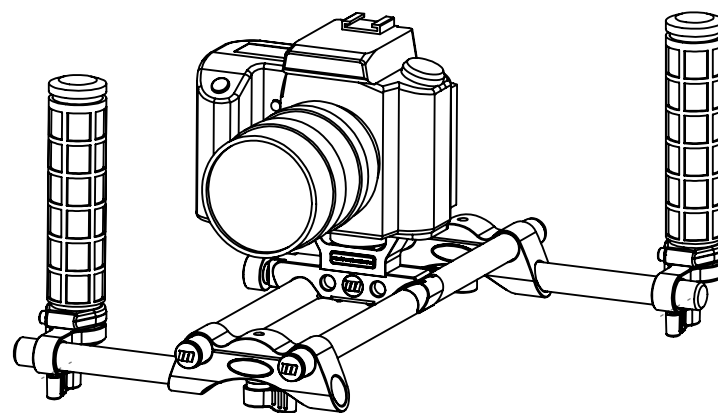

⑤ ASSEMBLY COMPLETED! NOW GO SHOOT!